



Beale Road, Tidworth

£290,000

 3  2  1



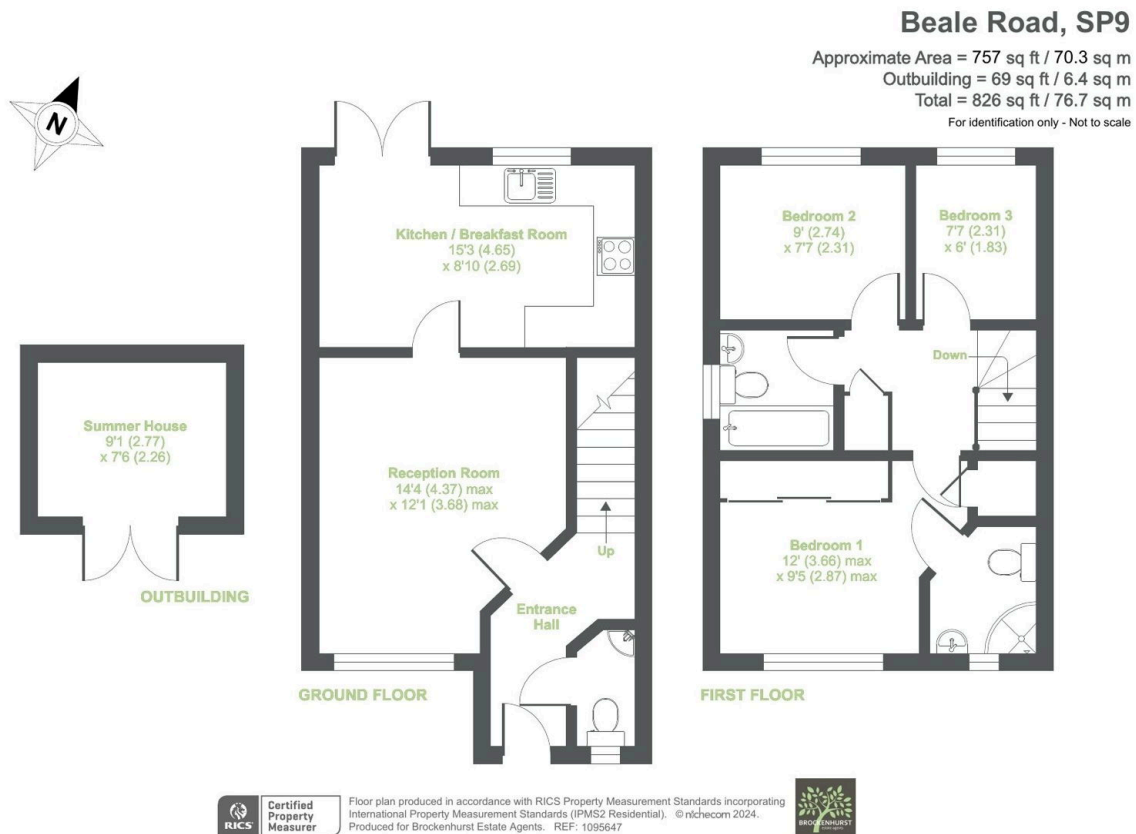

A stunning three bedroom home situated in Beale Road in Tidworth. Upon entry on this home you're greeted by an entrance hall with a cloakroom. To the left of the entrance hall there is the modernised living area that offers panelling on the walls. Following through the living room there is the kitchen/ breakfast room, that offers base level and wall hung units and has the added benefit of patio doors leading out onto the rear. The first floor offers three bedrooms, two of them have views of the rear garden. The master bedroom has built in storage and a three piece ensuite shower room. There is also a three piece family bathroom. The rear tiered garden of this

home is primarily laid to patio but features AstroTurf. There is a summer house located at the rear of the garden and there is side access to the front of the home. There is driveway parking at this home. Council Tax Band C.